



16 (13) bar
operating pressure

840 to 14,280 Nm³/h
volume flow rate

DN65 to DN300
connections

1,5 to 120 °C
operating temperature range

RAL 9005
standard colour CS series

CS: carbon steel

CS SS: stainless steel 1.4404
material

DESCRIPTION

CS condensate separators are designed for high efficient removal of bulk liquids and large impurities from compressed air systems. The insert inside the housing creates controlled rotation of the air flow. Centrifugal flow of liquids (water, oil) and large particles is forced to the housing wall, slowed down and accumulated at the bottom of separator housing as condensate.

The turbulent free zone in the lower part of the cyclone housing prevents condensate from being picked up and "carried over" into the airstream.

To discharge condensate from the CS cyclone separator it is essential to install automatic or electronic condensate drain. CS cyclone separators are also available in stainless steel version CS-SS.

Fluid group 1 on request.

APPLICATIONS

- Automotive
- Electronics
- Food and beverage
- Chemical
- Petrochemical
- Plastics
- Paint
- General industrial applications

CS/CS SS SERIES

WELDED CONDENSATE SEPARATORS



TD16MCr



page 110

AOK 20SS



page 115

AOK 13PA



page 113

AOK 20B



page 114

TD16M



page 110

ECD-B



page 104

EMD



page 102



TECHNICAL DATA

Model		Pipe size	Max.oper. pressure		Flow rate at 7 bar(g), 20 °C		Temperature oper. range		Dimensions [mm]				Mass
carbon steel	stainless steel	DN	CS bar/psi	CS SS bar/psi	Nm ³ /h	SCFM	°C	°F	A	B	C	D	kg
CS 14	CS SS 14	65	16/232	13/188	840	495	1,5 - 120	35 - 248	613	153	302	45	21
CS 28	CS SS 28	80	16/232	13/188	1.710	1.005	1,5 - 120	35 - 248	745	182	302	35	26
CS 62	CS SS 62	125	16/232	13/188	3.720	2.190	1,5 - 120	35 - 248	1041	280	390	43	58
CS 88	CS SS 88	150	16/232	13/188	5.280	3.110	1,5 - 120	35 - 248	1298	330	489	50	87
CS 124	CS SS 124	200	16/232	13/188	7.440	4.380	1,5 - 120	35 - 248	1506	436	619	52	147
CS 238	CS SS 238	300	16/232	13/188	14.280	8.404	1,5 - 120	35 - 248	1680	509	805	89	314

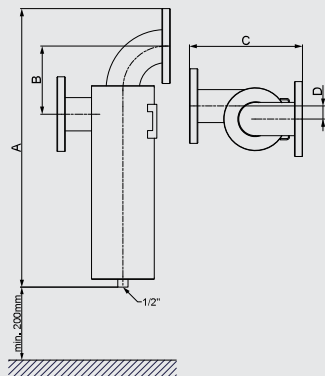

quality class - solids (ISO 8573-1)	-
quality class - water (ISO 8573-1)	8
quality class - oils (ISO 8573-1)	-
efficiency	>98%

CORRECTION FACTORS

Operating pressure [bar]	2	3	4	5	6	7	8	9	10	11	12	13	14	15	16
Operating pressure [psi]	29	44	58	72	87	100	115	130	145	160	174	189	203	218	232
Correction factor	0,38	0,50	0,63	0,75	0,88	1	1,13	1,25	1,38	1,50	1,63	1,75	1,88	2,00	2,13